

### 3D-matic for ø 7,2 mm drilling

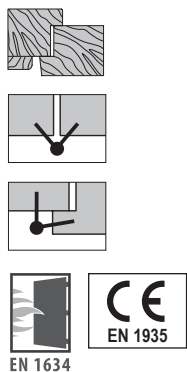

**Description**

Adjustable hinge made of zinc steel. ø 14 mm, with threaded pin 1,8 mm pitch. The dimensions and the axis of the central pins allow a unique drilling and mounting with 2 pin 46 mm Mod 118 hinge (E01174.14.XX).

**Adjustments:** three-dimensional adjustment possible (horizontal, vertical and depth) using a single 4 mm Allen wrench. A 3 mm wrench is used only for the vertical adjustment of the 14 mm diameter hinge.

- 1 Horizontal adjustment: made by adjusting the threaded pin on the upper body (to hold the sash perfectly plumb).
- 2 Depth adjustment: made by adjusting the threaded pin on the lower body (to apply the proper pressure to the gasket).
- 3 Vertical adjustment: 4 mm, through the thrust applied by a tapered screw onto the revolving ball set in the mobile pivot.

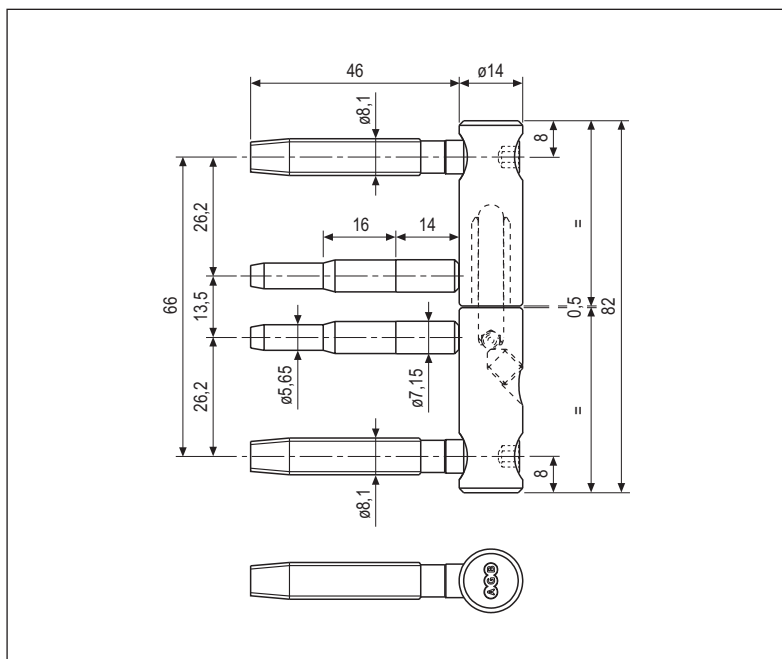



**NB.** Do not use the jigs dedicated to 3D Hinges E01150.XX.XX

**Order specifications**

Material	Article	ø
STEEL	E01178.14.XX	14

**NB.** Refer to the price list in force to check the availability of the finishes.

**Available covers**

	Standard model	<b>ABS:</b> Art. E01151 for ø14 mm
		<b>ALUMINIUM:</b> Art. E21151 for ø14 mm
		<b>BRASS:</b> Art. E01159 for ø14 mm
	Baroque model	<b>BRASS:</b> Art. E01153 for ø14 mm

**NB.** For complete dimensions and codes, see the "Covers" chapter.

