

## 20x170 mm striker - radius 6 mm, 8 mm fold

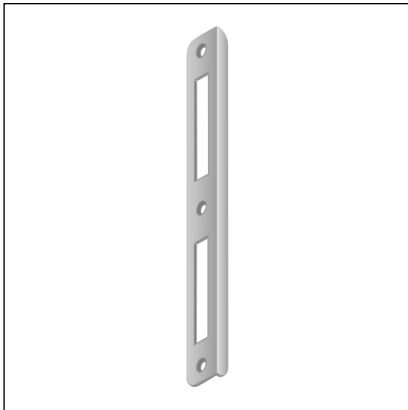

### Description

Steel striker with semiround ends, 20 mm wide, 170 mm long. L-shaped for protection of frame edge. Suitable for right and left-handed applications.

## Use

Used in combination with all the *Euro 72* lock versions with 18 and 20 mm forend, on interior rebated doors with timber frame.

## Fastening

Mill the frame according to the dimensions shown in the diagram. Install the striker flush with the edge of the frame.

Fasten with three 3,5x25 mm screws.

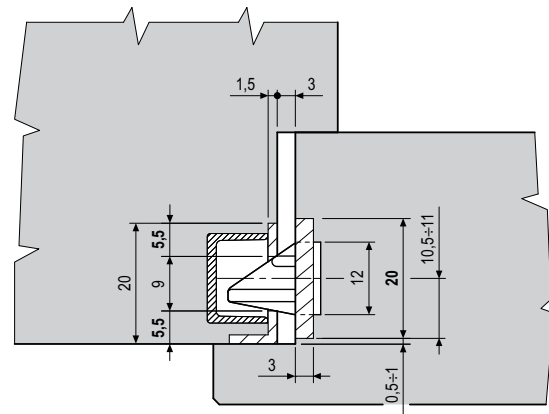
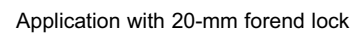
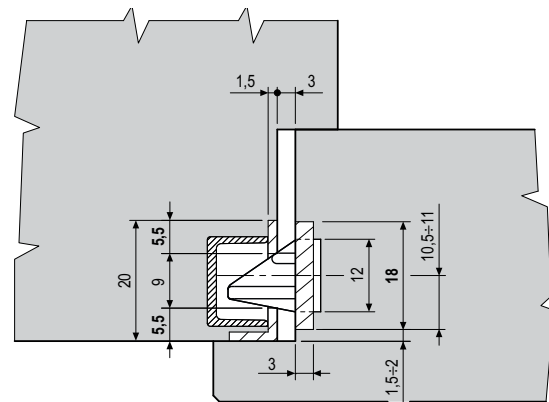
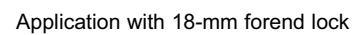
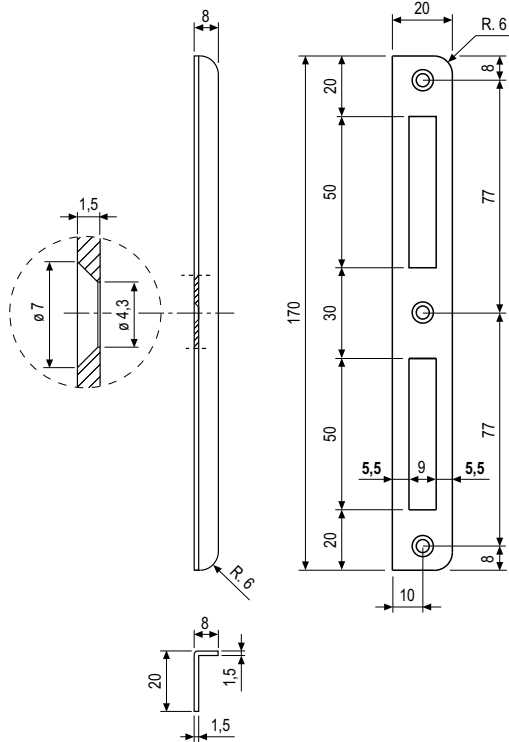

**Note.** Application executed without considering the thickness of the gaskets.

## Order Specifications

Material	Article	
STEEL	B10070.15 XX	

**Note.** Refer to the price list in force to check the availability of the finishes.