

25x204 mm striker - square ends with shaped lip



Description

Steel or brass striker with square ends, 24,5 mm wide - 204 mm long. 12 mm shaped lip for jamb protection in area where spring latch strikers. Suitable for both right and left-handed applications.

Application

Used in combination with a Mortice lock with spring latch, bolt and 22 mm forend, on interior and main flush doors with timber frame.

Mounting

Mill the frame according to the dimensions shown in the diagram and chisel the corners. Install the striker with the lip flush with the edge of the frame. Fasten with three 3x25 mm screws.

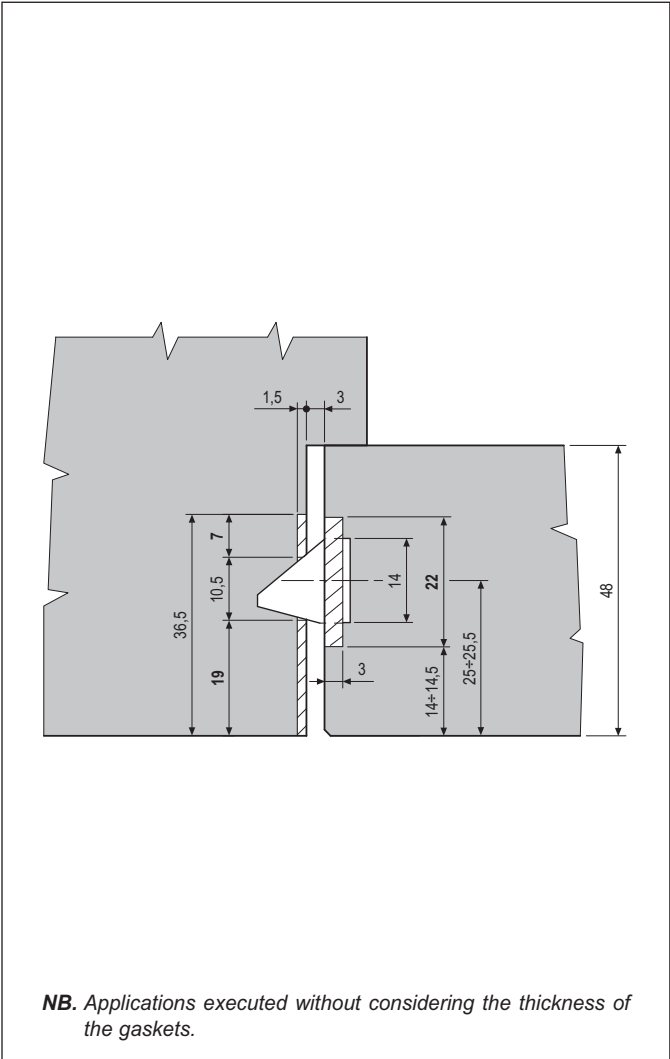
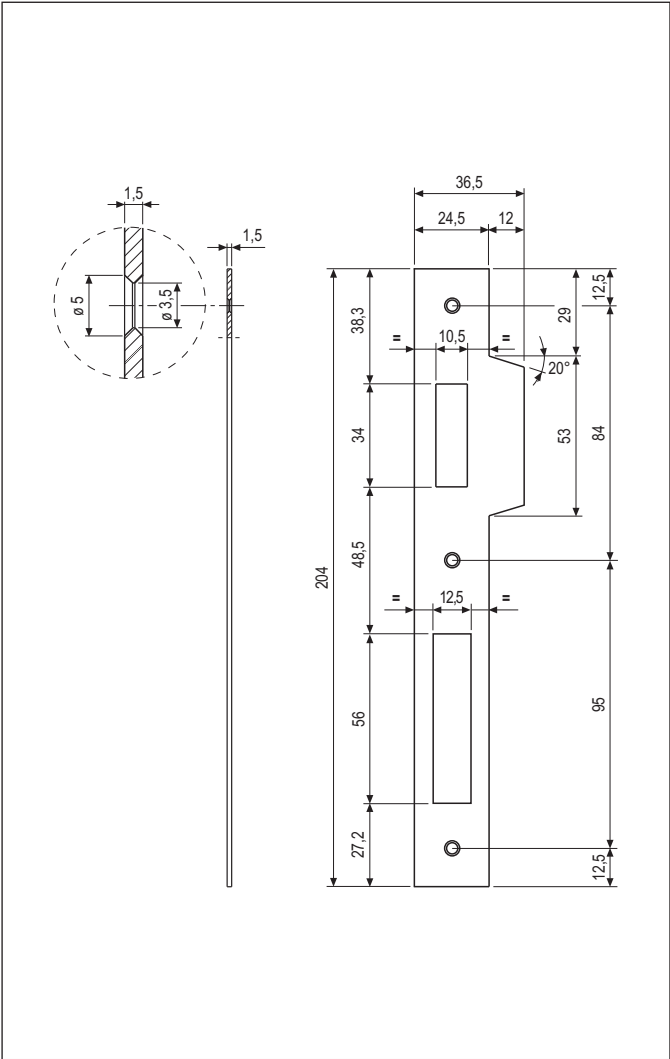

NB. Applications executed without considering the thickness of the gaskets.

Order Specifications

Material	SALES CODE			
	Ref.	Model	Finish	
STEEL	B00590	19	XX	
BRASS	B00590	20	XX	
STAINLESS STEEL	B04590	19	XX	

NB. Refer to the price list in force to check the availability of the finishes.